

# G5系列 / G5 Series

## 基本型微動開關 Basic Micro Switch



### ■特點/Features

- ◆ 結構緊湊，具有微小觸點間隙，快速動作、高靈敏度和微小動作行程的特點
- ◆ 長壽命，高可靠性
- ◆ 擁有全球安規認證
- ◆ 接線端子種類齊全
- ◆ 動作力範圍寬7gf~600gf
- ◆ 多種溫度等級-40°C~+150°C
- ◆ PTI等級有175V,250V,600V可供選擇
- ◆ 配備各種形式操作柄
- ◆ 廣泛應用於各種家用電器,電子設備,自動化設備,通訊設備,汽車電子,儀器儀表,電動工具等領域

- Tight Configuration, Small Contact Gap, Snap Action, High Sensitivity and Small Operating Travel
- Long Life, High Reliability
- Global Safety Approvals
- Variety of Terminals
- Wide Range Operating Force (7gf~600gf)
- Wide Range Temperature Grade (-40°C~+150°C)
- With Optional PTI Grade (175v, 250v, 600v)
- Variety of Levers
- Widely Used in Home Appliances, Electronic Equipments, Automatic Machines, Communication Equipments, Auto Electronics, Apparatus and Instrument, Power Tool etc

### ■应用/Application

- ◆ 家用電器
- ◆ 電子設備
- ◆ 自動化設備
- ◆ 通訊設備
- ◆ 汽車電子
- ◆ 儀器儀表
- ◆ 電動工具等領域

- Home Appliance
- Electronic Equipments
- Automatic Equipments
- Communication Equipments
- Auto Electronics
- Apparatus and Instruments
- Power Tools

### ■特性參數/Parameters:

工作速度 Operating Speed	0.1mm-1m/s(與驅動方式有關/ Related with actuator forms)	
工作頻率 Operating Frequency	機械60次/分鐘; 電氣15次/分鐘. Mechanical 60 cycles/min; Electrical 15 cycles/min.	
絕緣電阻 Insulation Resistance	≥100MΩ (500VDC)	
接觸電阻 Contact Resistance	≤100mΩ (初始值 / Initial value)	
耐電壓 Test Voltage	耐電壓- 同極不相接端子間 Between each terminals of the same polarity	AC1000V, 50/60HZ, 1min.
	耐電壓-帶電金屬零件與外殼之間,接線端與易觸及的不帶電金屬件之間/Betweencurrent-carrying metal part and ground, and between each terminal and non-current-carrying metal parts	AC1500V, 50/60HZ, 1min.
抗振動 Vibration Resistance	10-55HZ, 1.5mm 兩倍振幅 Double amplitude	
抗衝擊 Shock Resistance	破壞Destruction: 動作力/OF> 1.0N:1000m/s <sup>2</sup> (約/approx.100G)max. 動作力/OF≤ 1.0N:400m/s <sup>2</sup> (約/approx.40G)max. 故障Destruction: 動作力/OF> 1.0N:200m/s <sup>2</sup> (約/approx.20G)max. 動作力/OF≤ 1.0N:100m/s <sup>2</sup> (約/approx.10G)max.	
壽命 Service Life	機械/Mechanical ≥ 10,000,000次/cycles 或/ or 1,000,000次/cycles	
	電氣/Electrical ≥ 50,000次/cycles 或/ or 100,000次/cycles, 取決於類型 Depends on Part No.	
單重 Unit Net Weight	約6.2g (無操作柄) Approx. 6.2g (No lever).	

# G5系列微動開關訂貨型號指引

## G5 Series Micro Switch Ordering Instruction

G5	T	16	C	Z	200	A	01	K	XX
開關類別 Switch Type	溫度等級 Temperature grade	額定電流 Electrical Rating	端子類別 Terminal Type	接線形式 Circuit Code	操作力 (最大值) 數據在不帶 Max Operating Force at pin Plunger	接桿位置 Lever Position	接桿類型 Lever Type	安裝孔尺寸 Mounting Holes	特別設計代碼 Special Designator
G5 系列微動開關 G5 Series Micro-Switch	S (僅針對5安培電流 for "05" rating Only)	05 ENEC/CQC: 0.1A 48VDC 0.1A 125/250VAC 5(2.5)A 125/250VAC, 5E4,u UL/CUL: 0.1A 48VDC 0.1A 125/250VAC 5A 1/10HP 125/250VAC (僅適用於 "S" 型溫度等級/Temperature grade only 僅適用於Only apply to C,C1,C2,E,E1,E2,D,D1,D2,S, S1,S2,F,F1)	C C1 C2 6.30x0.80mm 0.250"x0.032" 快捷端子 Quick Connect Terminals	Z SPDT 單級雙投	015 15gf note: 1. 僅適用於/Only apply to G5S05, G5W11(Rating1) series.	不帶操作柄 柱式接桿 No lever Pin Plunger	不帶操作柄 柱式接桿 No lever Pin Plunger	Metric ø3.1mm	此處為特別設計代碼，具體 請參考產品規格來確定詳細 的差別 Here means a special designator letter.Refer to products specification for detailed differences.
	T 25T125	08 ENEC/CQC: 8(10)A 250VAC,5E4,25T125 UL/CUL 10.1A 1/2HP 250VAC (以上僅適用於"溫度等級和觸點間距>3mm的開關和僅適 用于C2,D2端子類別和"300gf/500gf"操作力/Above only for"B" temperature grade and switch of contact gap>3mm) and only with C2 and D2 terminals;"300"-500" OF Only)	D D1 D2 4.70x0.8mm 0.187"x0.032" 快捷端子 Quick Connect Terminals	P SPST-NO 單級單投 -常閉	025 25gf note: 1. 僅適用於/Only apply to G5S05, G5W11(Rating1) series.	A 遠高柱式接桿 位置 Far From Pin Plunger	短重新 Short Straight Lever	K USA ø2.9mm	H Rast-5 250# terminal. N Rast-7 250# terminal. P Straight PCB Terminal A Contact gold plated.
G5D 門開關 G5 Door Switch	H 25T150	10 UL/CUL: 11A 1/3HP 125/250VAC 0.5A 125VDC 0.25A 250VDC 4A 125VAC L ENEC/CQC 10(3)A 125/250VAC,0.5A 125VDC 0.25A 250VDC 25T125 u SE4 (以上僅適用於"溫度等級適用/Above only for" temperature grade) 僅適用於/C,C1,C2,E,E1,E2,D,D1,D2,F,F1 Terminal only.	E E1 E2 4.70x0.5mm 0.187"x0.020" 快捷端子 Quick Connect Terminals	C SPST-NC 單級單投 -常閉	050 50gf 0.49N Note: 1. 僅適用於/Only apply to G5D05, G5T10, G5W11(rating 1 & rating 2)series	B 靠近柱式接桿 位置 Close to Pin Plunger	02: 標準直柄 Std. Straight Lever	U 合金底座 內置 安裝孔 Alloy base with inner mounting hole Only for G5D Door Switch	W1 G5W11 Rating 1 (NOTE:標準線長/Standard wire:UL1015,24#,300mm) W2 G5W11 Rating 2 NOTE:標準線長/Standard wire:UL1015,20#,300mm) W3 G5W11 Rating 3 NOTE:標準線長/Standard wire:UL1015,18#,300mm) (Note:僅適用於G5W11,其他線型 /線長可選. Only apply to G5W11, Other wire type/length is optional)
	B 25T125 僅"05"等級適用 且線長 >3mm Only for"05"rating and contact gap>3mm	11 ENEC/CQC: Rating 1: 0.1A 48VDC, 0.1A 125/250VAC,40T85,5E4,u Rating 2: 5A 125/250VAC,5A, 30VDC,40T85,5E4, u Rating 3: 10(2)A 125/250VAC, 0.5A 125VDC, 0.25A 250VDC,40T85,u,2E4 UL/CUL: Rating 1: 0.1A 48VDC,0.1A 125/250VAC,T85 Rating 2: 5A 125/250VAC, 5A, 30VDC, T85 Rating 3: 10.1A, 1/10HP 125/250VAC,0.5A 125VDC, 0.25A 250VDC, T85 (以上僅適用於"W"溫度等級/"W" Temperature grade only. 僅適用於 "D","E","W"端子類別/"D","E","W" Terminals only.	L L1 L2 左側面PCB 端子 Left Angled PCB Terminals	F 推桿 Push Rod G5D Door switch only.	100 100gf 0.98 N Note: Note: 16A and 22A Minimum OF is 100gf. 16A/22A最小操作力為100gf	F 長重新 Long Straight Lever	V 合金底座 外置 安裝孔 Alloy base with outer mounting hole Only for G5D Door Switch	W 合金底座 外置 安裝孔 Alloy base with two switches Only for G5D Door Switch	
W 40T85 16C 1P67 僅適用於電線安裝 "11"Only for Electrical rating "11"	16 ENEC/CQC: 16(4)A 250VAC u SE4 UL/CUL: 16A 1/2HP 125/250VAC	R R1 R2 右側面PCB 端子 Right Angled PCB Terminals	J 螺絲推桿 Screw Push Rod G5D Door switch only.	200 200gf 1.96N Note: G5S05, G5T10, G5W11 Series /最大操作力為 200gf/with medium OF is 200gf; 28A,最低操作力為Min OF is 200gf	J 模擬滾輪手柄 Simulated Roller Lever	04: 滾輪 Roller Lever	W 合金底座 外置 安裝孔 Alloy base with two switches Only for G5D Door Switch		
	22 ENEC/CQC: 22(8)A 250VAC u 1E4 UL/CUL: 22A 1HP 125/250VAC	S S1 S2 焊接端子 Solder Terminals	300 300gf 2.94N Note: 不適用於/Not apply to G5S05, G5T10,G5W11 Series	05: 帶滾輪手柄 Roller Lever	05: 帶滾輪手柄 Roller Lever	05: 帶滾輪手柄 Roller Lever	05: 帶滾輪手柄 Roller Lever		
	26 ENEC/CQC: 26(10)A 250VAC, 0.02A 250VAC, 25E3 u	T T1 T2 螺絲端子 Screw Terminals	400 400gf 3.92N Note: 不適用於/Not apply to G5S05, G5T10,G5W11 Series	06: 帶長滾輪手柄 Long Roller Lever	06: 帶長滾輪手柄 Long Roller Lever	06: 帶長滾輪手柄 Long Roller Lever	06: 帶長滾輪手柄 Long Roller Lever		
	W 外線導線 With Lead Wires (For G5W11 Series only)	500 500gf 4.90N "B" Temperature grade only.	500 500gf 4.90N "B" Temperature grade only.	10: 短塑料滾輪手柄 Short Plastic Roller Lever	10: 短塑料滾輪手柄 Short Plastic Roller Lever	10: 短塑料滾輪手柄 Short Plastic Roller Lever	10: 短塑料滾輪手柄 Short Plastic Roller Lever		
...	...	...	1800gf 1800gf 17.64N "G5D Door switch" only.	11: 長塑料滾輪手柄 Long Plastic Roller Lever	11: 長塑料滾輪手柄 Long Plastic Roller Lever	11: 長塑料滾輪手柄 Long Plastic Roller Lever	...	...	
Note: 其他線型的端子有/Other available lever include: 088,099,236,248,328,456, 468...									

備注：僅字母時用于基本型外殼  
字母+數字時用于平端型外殼  
Note: Letters only for Basic Type Housing  
Letters and number for Flat Type Housing.

說明Description:  
電流與操作力關係，各電流等級對應最小操作力等級  
Relationship between current and OF,the min. OF classify  
for each rating  
0.1A~0.5A: 15gf,  
5A:25gf  
10A: 25gf  
16A: 100gf  
22A:100gf (不推薦/don't recommend)  
22A:200gf (推薦recommend)  
26A:200gf  
08(10)A:200gf  
G5W11(rating 2): 50gf  
G5W11(rating 3): 100gf

**G5系列**  
**G5 Series**

**安裝孔位、操作柄類型、接觸形式、外形介紹、端子類**  
**Mounting Hole, Lever Type, Circuit, Shape, Terminal Type**

**■ 內部構造圖/Inner Construction**

普通型 General Type	G5S05/G5T10	觸點間距>3mm Contact Gap>3mm
1.操作柄/Lever 2.按墊/Plunger 3.膠蓋/Cover	4.支杆/Internal Lever 5.公共端子/Common Terminal	7.NC/NO端子/NO/NC Terminals 8.膠座/Case 9.動片/Movable Plate 10.彈片/彈簧 (右圖) Spring

**■ 外形特徵/Housing Outline Characteristics**

基本形/Basic Type 配端子:C,D,E,L,R... Optional Terminal	平端形/Flat Type 配端子:C1,D1,E1,L1,R1... Optional Terminal	完全平端形/Fully Flat Type 配端子:C2,D2,E2,L2,R2... Optional Terminal

**■ 安裝孔尺寸/Mounting Hole Dimensions**

(單位/Unit:mm)

基本形 Basic Type	K形 K Type	左側面PCB端子 Left Angled PCB Terminal	右側面PCB端子 Right Angled PCB Termin

**■ 接觸形式圖/Circuit Configuration**

公共端類型/Common Terminal Type	"Z"轉換式SPDT	"C"常閉式SPST-NC	"P"常開式SPST-NO
公共端在底部 Common Terminal at bottom			

■ 接線端子尺寸/Connect Terminal Dimensions

◆ 基本型膠殼/Terminals for Basic Type Housing

(單位/Unit:mm)

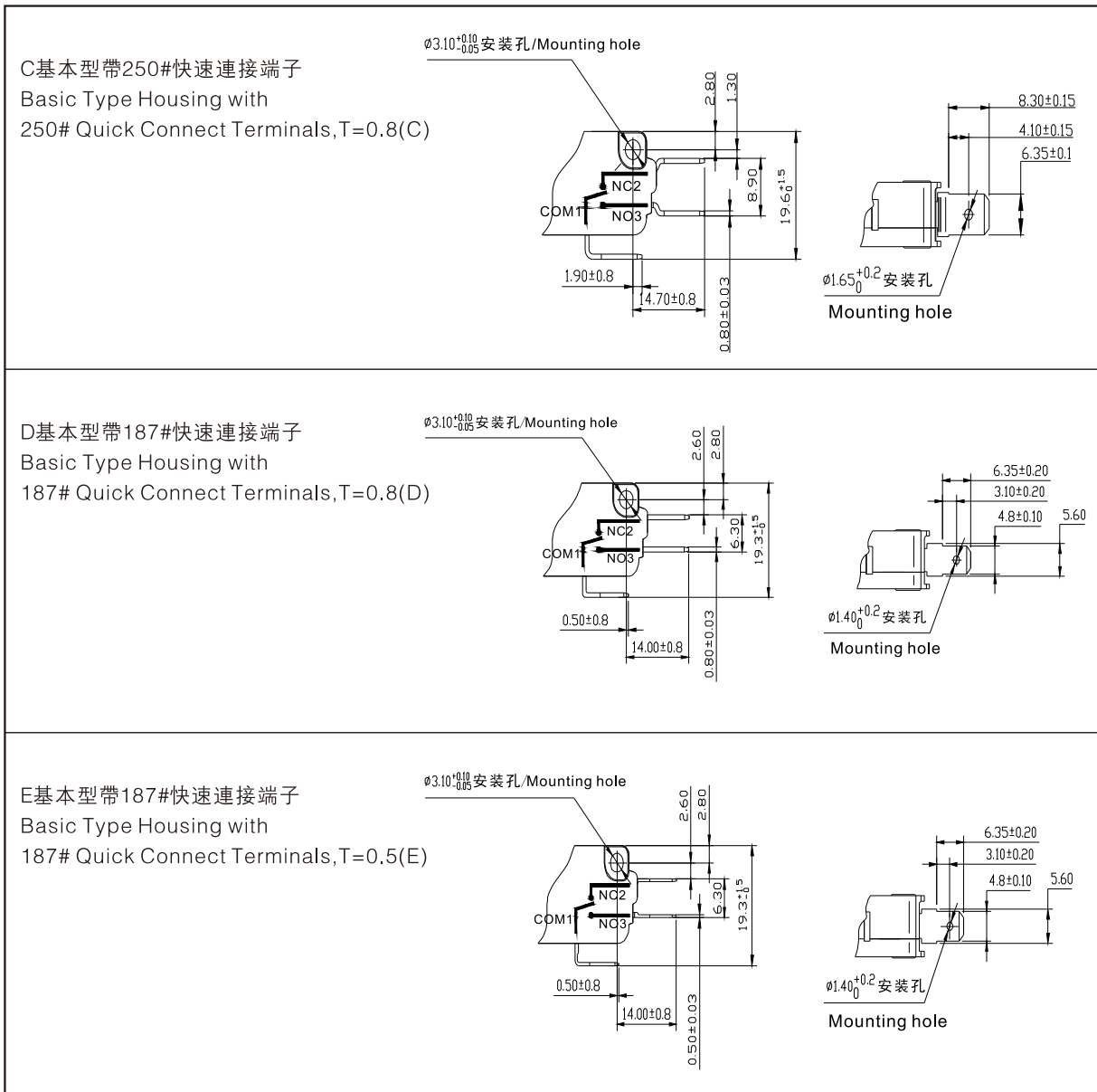

◆ 平端型膠殼/Terminals for Flat Type Housing

(單位/Unit:mm)

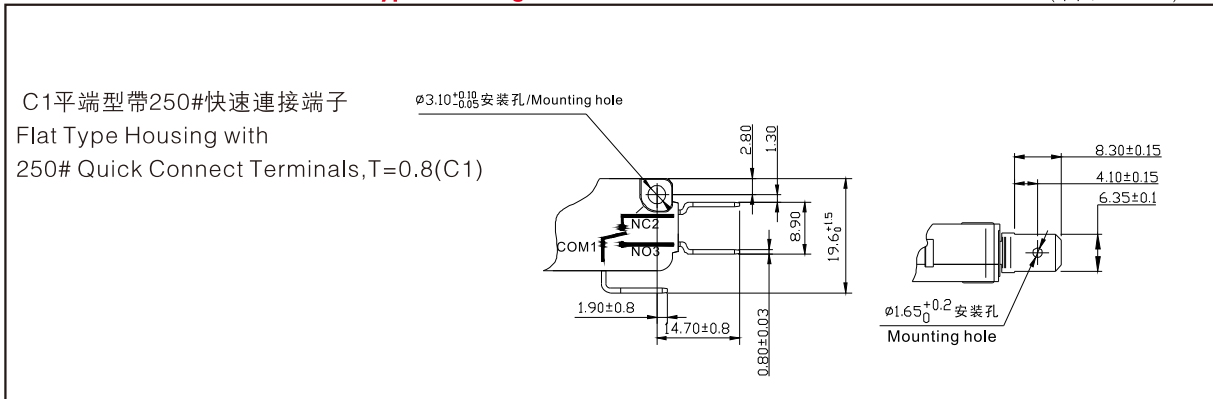

(单位/Unit:mm)

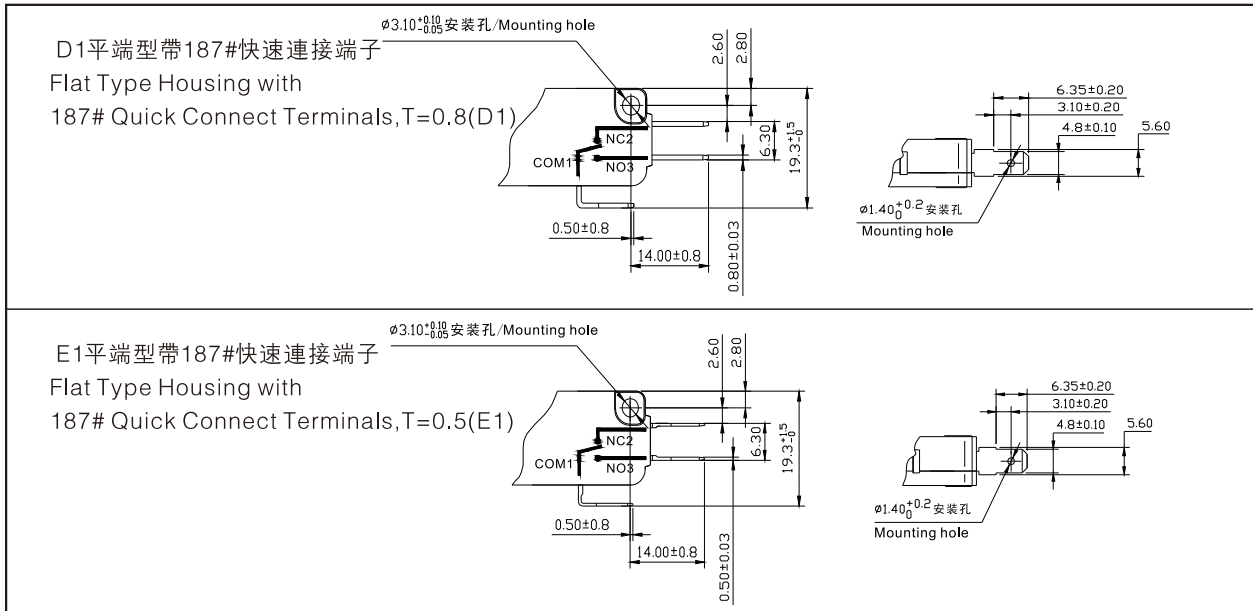

◆ 完全平端型膠殼/Terminals for Fully Flat Type Housing

(单位/Unit:mm)

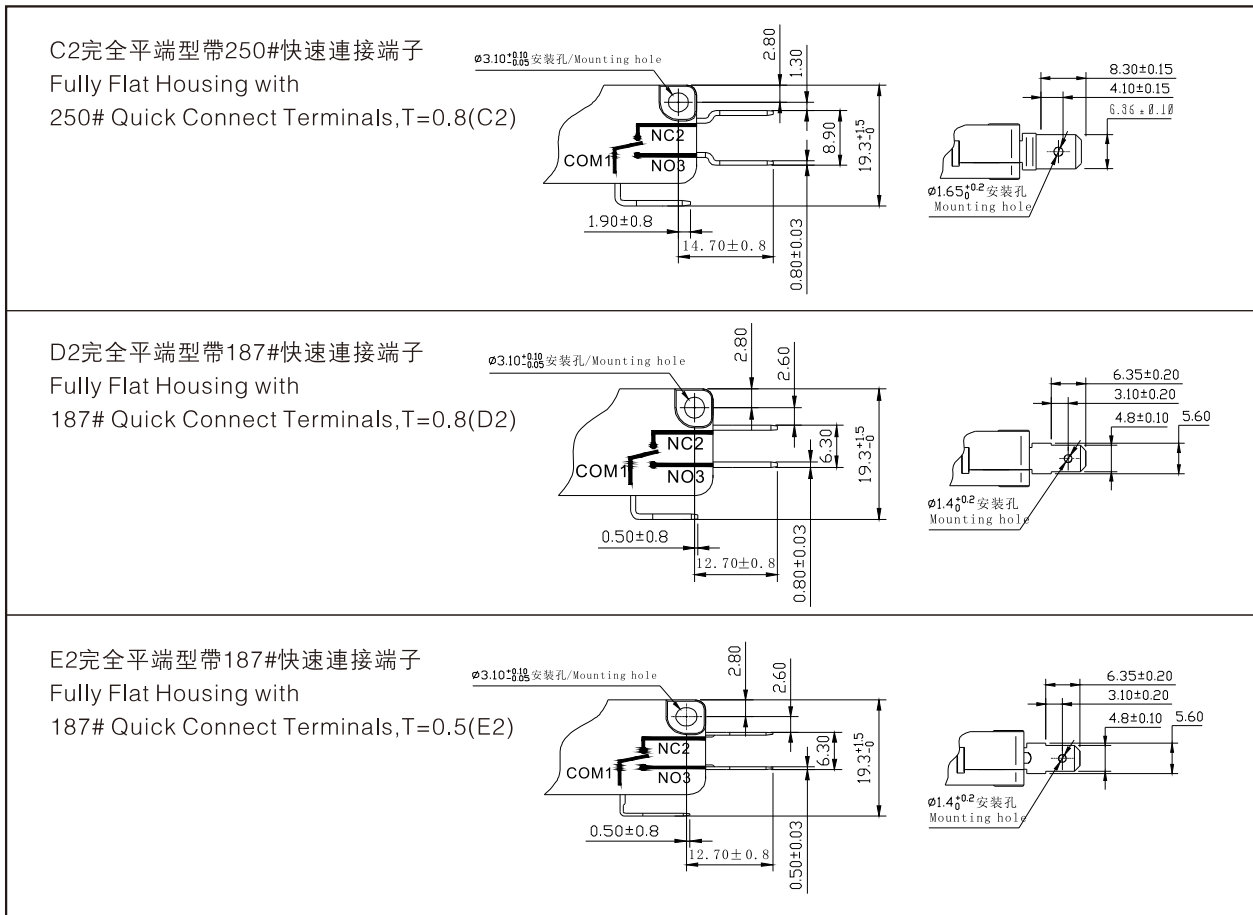

◆ 其他端子類型/Other Terminal Type

<p><b>L</b> 左側面PCB端子 Left Angled PCB Terminal</p>	<p><b>R</b> 右側面PCB端子 Right Angled PCB Terminal</p>	<p><b>T</b> 螺孔端子 Screw Terminal</p>
<p><b>F</b> 傾斜螺孔端子 Slant Screw Terminal</p>	<p><b>S</b> 標準焊綫端子 Standard Solder Terminal</p>	<p><b>K</b> 長形孔焊綫端子 Rectangle Hole Solder Terminal</p>
<p><b>M</b> 短焊綫端子 Short Solder Terminal</p>	<p><b>H</b> RAST-5</p>	<p><b>N</b> RAST-7</p>
<p><b>P</b> 直PCB端子 Straight PCB Terminal</p>	<p>IP67防塵防水 IP67 Water Proof and Dust Proof</p>	<p>IP67防塵防水 (端子除外) IP67 Water Proof and Dust Proof (Exclude Terminals)</p>

◆ 其他手柄類型/Other Lever Type

<p>#08手柄 Lever #08</p>	<p>#32手柄 Lever #32</p>
<p>#09手柄 Lever #09</p>	<p>#45手柄 Lever #45</p>
<p>#23手柄 Lever #23</p>	<p>#46手柄 Lever #46</p>
<p>#24手柄 Lever #24</p>	

## ◆ 外形尺寸和操作特性 Dimensions and Operating Characteristics

(单位/Unit:mm)

### ◆ 柱式按挚 Pin Plunger

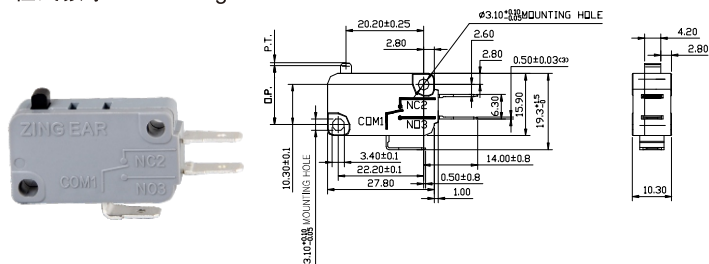

型号 Part No.	操作参数/Parameters							
	OF Max.		RF Min.		PT Max.	OT Min.	MD Max.	OP
	(N)	(gf)	(N)	(gf)	(mm)	(mm)	(mm)	(mm)
G5□□□-E1Z015	0.15	15	0.03	3	1.6	0.8	0.4	14.7±0.5
G5□□□-E1Z025	0.25	25	0.05	5	1.6	0.8	0.4	14.7±0.5
G5□□□-E1Z050	0.49	50	0.10	10	1.6	0.8	0.4	14.7±0.5
G5□□□-E1Z100	0.98	100	0.25	25	1.6	0.8	0.4	14.7±0.5
G5□□□-E1Z200	1.96	200	0.49	50	1.6	0.8	0.4	14.7±0.5
G5□□□-E1Z300	2.94	300	0.74	75	1.6	0.8	0.4	14.7±0.5
G5□□□-E1Z400	3.92	400	0.98	100	1.6	0.8	0.4	14.7±0.5

### ◆ 短直柄 Short Straight Lever

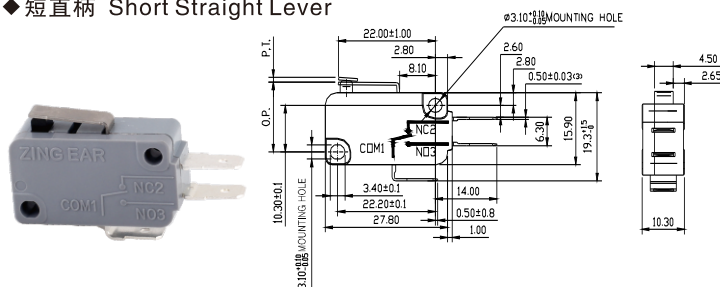

型号 Part No.	操作参数/Parameters							
	OF Max.		RF Min.		PT Max.	OT Min.	MD Max.	OP
	(N)	(gf)	(N)	(gf)	(mm)	(mm)	(mm)	(mm)
G5□□□-E1Z015A01	0.15	15	0.03	3	1.6	0.8	0.4	15.3±0.5
G5□□□-E1Z025A01	0.25	25	0.05	5	1.6	0.8	0.4	15.3±0.5
G5□□□-E1Z050A01	0.49	50	0.10	10	1.6	0.8	0.4	15.3±0.5
G5□□□-E1Z100A01	0.98	100	0.25	25	1.6	0.8	0.4	15.3±0.5
G5□□□-E1Z200A01	1.96	200	0.49	50	1.6	0.8	0.4	15.3±0.5
G5□□□-E1Z300A01	2.94	300	0.74	75	1.6	0.8	0.4	15.3±0.5
G5□□□-E1Z400A01	3.92	400	0.98	100	1.6	0.8	0.4	15.3±0.5

### ◆ 标准直柄 Standard Straight Lever

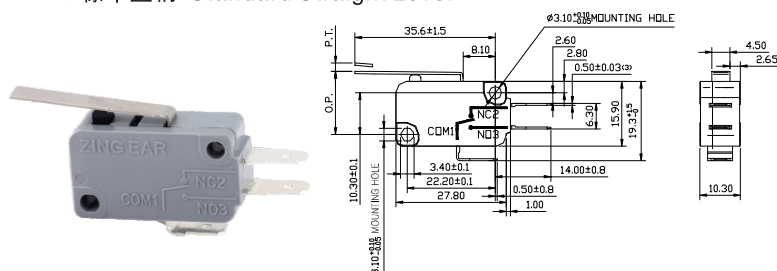

型号 Part No.	操作参数/Parameters							
	OF Max.		RF Min.		PT Max.	OT Min.	MD Max.	OP
	(N)	(gf)	(N)	(gf)	(mm)	(mm)	(mm)	(mm)
G5□□□-E1Z015A02	0.10	10	0.02	2	3.2	1.3	1.2	15.3±1.5
G5□□□-E1Z025A02	0.15	15	0.02	2	3.2	1.3	1.2	15.3±1.5
G5□□□-E1Z050A02	0.29	30	0.05	5	3.2	1.3	1.2	15.3±1.5
G5□□□-E1Z100A02	0.59	60	0.10	10	3.2	1.3	1.2	15.3±1.5
G5□□□-E1Z200A02	1.18	120	0.20	20	3.2	1.3	1.2	15.3±1.5
G5□□□-E1Z300A02	1.77	180	0.29	30	3.2	1.3	1.2	15.3±1.5
G5□□□-E1Z400A02	2.35	240	0.39	40	3.2	1.3	1.2	15.3±1.5

### ◆ 长直柄 Long Straight Lever

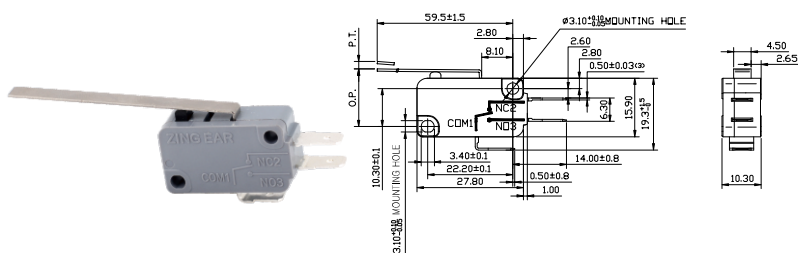

型号 Part No.	操作参数/Parameters							
	OF Max.		RF Min.		PT Max.	OT Min.	MD Max.	OP
	(N)	(gf)	(N)	(gf)	(mm)	(mm)	(mm)	(mm)
G5□□□-E1Z015A03	0.07	7	0.02	2	6.4	2.6	2.4	15.3±3
G5□□□-E1Z025A03	0.10	10	0.02	2	6.4	2.6	2.4	15.3±3
G5□□□-E1Z050A03	0.15	15	0.02	2	6.4	2.6	2.4	15.3±3
G5□□□-E1Z100A03	0.29	30	0.05	5	6.4	2.6	2.4	15.3±3
G5□□□-E1Z200A03	0.59	60	0.10	10	6.4	2.6	2.4	15.3±3
G5□□□-E1Z300A03	0.88	90	0.15	15	6.4	2.6	2.4	15.3±3
G5□□□-E1Z400A03	1.18	120	0.20	20	6.4	2.6	2.4	15.3±3

### ◆ 模拟滚轮手柄 Simulated Roller Lever

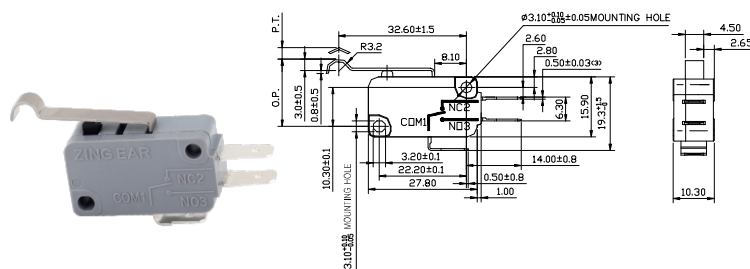

型号 Part No.	操作参数/Parameters							
	OF Max.		RF Min.		PT Max.	OT Min.	MD Max.	OP
	(N)	(gf)	(N)	(gf)	(mm)	(mm)	(mm)	(mm)
G5□□□-E1Z015A04	0.10	10	0.02	2	3.2	1.3	1.2	18.3±1.5
G5□□□-E1Z025A04	0.15	15	0.02	2	3.2	1.3	1.2	18.3±1.5
G5□□□-E1Z050A04	0.29	30	0.02	2	3.2	1.3	1.2	18.3±1.5
G5□□□-E1Z100A04	0.59	60	0.10	10	3.2	1.3	1.2	18.3±1.5
G5□□□-E1Z200A04	1.18	120	0.20	20	3.2	1.3	1.2	18.3±1.5
G5□□□-E1Z300A04	1.77	180	0.30	30	3.2	1.3	1.2	18.3±1.5
G5□□□-E1Z400A04	2.35	240	0.39	40	3.2	1.3	1.2	18.3±1.5

## ◆短滾輪手柄 Short Roller Lever

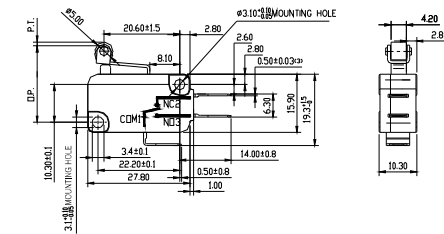

型号 Part No.	操作参数/Parameters							
	OF Max.		RF Min.		PT Max.	OT Min.	MD Max.	OP Max.
	(N)	(gf)	(N)	(gf)	(mm)	(mm)	(mm)	(mm)
G5□ □ -E1Z015A05	0.15	15	0.03	3	1.6	0.8	0.4	20.6±0.8
G5□ □ -E1Z025A05	0.30	30	0.05	5	1.6	0.8	0.4	20.6±0.8
G5□ □ -E1Z050A05	0.59	60	0.10	10	1.6	0.8	0.4	20.6±0.8
G5□ □ -E1Z100A05	1.18	120	0.20	20	1.6	0.8	0.4	20.6±0.8
G5□ □ -E1Z200A05	2.35	240	0.39	40	1.6	0.8	0.4	20.6±0.8
G5□ □ -E1Z300A05	3.43	350	0.59	60	1.6	0.8	0.4	20.6±0.8
G5□ □ -E1Z400A05	4.60	470	0.78	80	1.6	0.8	0.4	20.6±0.8

## ◆長滾輪手柄 Long Roller Lever

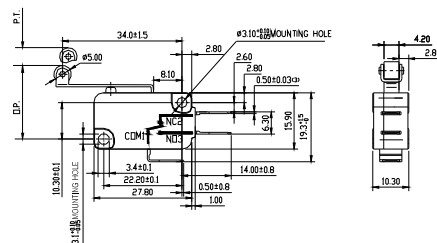

型号 Part No.	操作参数/Parameters							
	OF Max.		RF Min.		PT Max.	OT Min.	MD Max.	OP Max.
	(N)	(gf)	(N)	(gf)	(mm)	(mm)	(mm)	(mm)
G5□ □ -E1Z015A06	0.10	10	0.02	2	3.2	1.3	1.2	20.6±1.6
G5□ □ -E1Z025A06	0.15	15	0.02	2	3.2	1.3	1.2	20.6±1.6
G5□ □ -E1Z050A06	0.29	30	0.05	5	3.2	1.3	1.2	20.6±1.6
G5□ □ -E1Z100A06	0.59	60	0.10	10	3.2	1.3	1.2	20.6±1.6
G5□ □ -E1Z200A06	1.18	120	0.20	20	3.2	1.3	1.2	20.6±1.6
G5□ □ -E1Z300A06	1.77	180	0.29	30	3.2	1.3	1.2	20.6±1.6
G5□ □ -E1Z400A06	2.35	240	0.39	40	3.2	1.3	1.2	20.6±1.6

## ◆柱式按墊250#端子 Pin Plunger, 250# Terminals

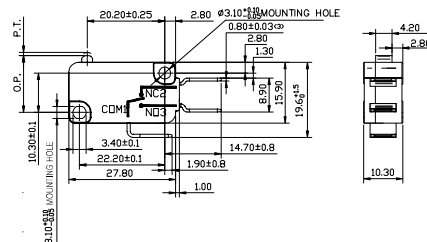

型号 Part No.	操作参数/Parameters							
	OF Max.		RF Min.		PT Max.	OT Min.	MD Max.	OP Max.
	(N)	(gf)	(N)	(gf)	(mm)	(mm)	(mm)	(mm)
G5□ □ -C1Z015	0.15	15	0.03	3	1.6	0.8	0.4	14.7±0.5
G5□ □ -C1Z025	0.25	25	0.05	5	1.6	0.8	0.4	14.7±0.5
G5□ □ -C1Z050	0.49	50	0.10	10	1.6	0.8	0.4	14.7±0.5
G5□ □ -C1Z100	0.98	100	0.25	25	1.6	0.8	0.4	14.7±0.5
G5□ □ -C1Z200	1.96	200	0.49	50	1.6	0.8	0.4	14.7±0.5
G5□ □ -C1Z300	2.94	300	0.74	75	1.6	0.8	0.4	14.7±0.5
G5□ □ -C1Z400	3.92	400	0.98	100	1.6	0.8	0.4	14.7±0.5

## ◆柱式按墊帶頭殼體250#端子 Pin Plunger Basic Type Housing, 250# Terminals

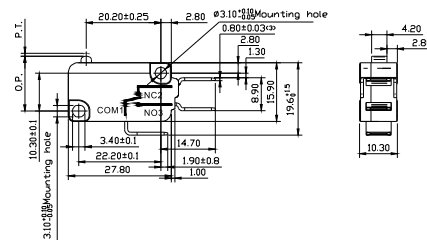

型号 Part No.	操作参数/Parameters							
	OF Max.		RF Min.		PT Max.	OT Min.	MD Max.	OP Max.
	(N)	(gf)	(N)	(gf)	(mm)	(mm)	(mm)	(mm)
G5□ □ -CZ015	0.15	15	0.03	3	1.6	0.8	0.4	14.7±0.5
G5□ □ -CZ025	0.25	25	0.05	5	1.6	0.8	0.4	14.7±0.5
G5□ □ -CZ050	0.49	50	0.10	10	1.6	0.8	0.4	14.7±0.5
G5□ □ -CZ100	0.98	100	0.25	25	1.6	0.8	0.4	14.7±0.5
G5□ □ -CZ200	1.96	200	0.49	50	1.6	0.8	0.4	14.7±0.5
G5□ □ -CZ300	2.94	300	0.74	75	1.6	0.8	0.4	14.7±0.5
G5□ □ -CZ400	3.92	400	0.98	100	1.6	0.8	0.4	14.7±0.5

## ◆柱式按墊帶頭殼體187#端子 Pin Plunger Basic Type Housing, 187# Terminals

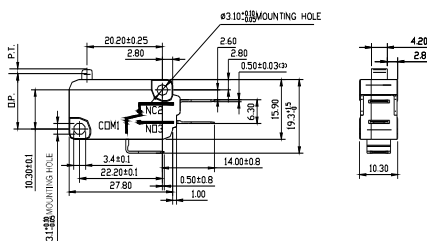

型号 Part No.	操作参数/Parameters							
	OF Max.		RF Min.		PT Max.	OT Min.	MD Max.	OP Max.
	(N)	(gf)	(N)	(gf)	(mm)	(mm)	(mm)	(mm)
G5□ □ -EZ015	0.15	15	0.03	3	1.6	0.8	0.4	14.7±0.5
G5□ □ -EZ025	0.25	25	0.05	5	1.6	0.8	0.4	14.7±0.5
G5□ □ -EZ050	0.49	50	0.10	10	1.6	0.8	0.4	14.7±0.5
G5□ □ -EZ100	0.98	100	0.25	25	1.6	0.8	0.4	14.7±0.5
G5□ □ -EZ200	1.96	200	0.49	50	1.6	0.8	0.4	14.7±0.5
G5□ □ -EZ300	2.94	300	0.74	75	1.6	0.8	0.4	14.7±0.5
G5□ □ -EZ400	3.92	400	0.98	100	1.6	0.8	0.4	14.7±0.5

# G5系列 Series-G5W

## 密封型防水防塵微動開關 Sealed Micro Switch



### ■特點/Features

- ◆防水防塵設計,可以在會淋水或多塵埃的地方使用.
- ◆結構緊湊,具有微小觸點間隙,快速動作、高靈敏度和微小動作行程的特點
- ◆長壽命,高精度、高可靠性,安裝和G5系列相同.
- ◆可在汽車、農業機械、大型家電、辦公設備等有耐環境性要求的場合使用
- ◆最大ENEC/UL認證電流達10A

- Water Proof and Dust Proof
- Tight Structure、Small Contact Gap  
Snap Action、High Sensitivity
- Long Life,high Precision and Reliability
- Widely used in Auto、Agricultural Equipment、Applications,Office Equipment etc
- Max Approved Current at ENEC/UL is10A

### ■應用/Application

- ◆家用電器
- ◆電子設備
- ◆自動化設備
- ◆汽車電子
- ◆農業機械
- ◆辦公設備

- Home Appliances
- Electronic Devices
- Automatic Equipments
- Auto Electronics
- Agricultural Equipments
- Office Equipments

### ■特性參數/Parameters:

額定值Rating	W1	ENEC 0.1A 48VDC, 0.1A 125/250VAC,40T85,5E4,u UL 0.1A 48VDC,0.1A 125/250VAC,T85
	W2	ENEC: 5A 125/250VAC,5A, 30VDC,40T85,5E4, u UL: 5A 125/250VAC,5A 30VDC T85
	W3	ENEC 10(2)A 125/250VAC, 0.5A 125VDC, 0.25A 250VDC,40T85,u,2E4 UL 10.1A 1/10HP 125/250VAC,0.5A 125VDC, 0.25A 250VDC, T85
容許操作頻率 Operating Frequency	電氣Electrical	10~30次/分 times/min
	機械Mechanical	60次/分 times/min
接觸電阻 ( 初始值 ) Contact Resistance(Intial Value)	端子型with terminal type	最大50mΩ;50mΩ Max
	導線型with wire type	最大100mΩ;100mΩ Max (取決于導線的長短/Depends on the length of the wire)
絕緣電阻Insulation Resistance		在500VDC 時/at 500VDC, 100MΩ Min.
抗電強度Dielectric Strength	同極端子間 Between terminals	AC 1000V 50~60Hz 1min
	端子外殼間Between terminals and housing	AC 1500V 50~60Hz 1min
保存溫度Storage Temperature		-40° C ~ +85° C
保存濕度Storage Humidity		85%RH Max
保護結構Protection Grade	端子型 With terminal type	IEC IP67 ( 端子部除外exclude terminal )
	導線型 With wire type	IEC IP67
防觸電保護級Electric-shock safeguard grade		Class II
PTI ( 漏電特性 )		250
壽命Life	電氣E-life	2萬次 ~ 10萬次以上 ( 取決于類型 ) 2E4 ~ 10E4 cycles(depends on P/Ns)
	機械M-life	100萬次以上 ( 60次/分Times/min ) ;over 1,000,000cycles(60cycles/min)
單重Unit Net Weight		約7g ( 端子型、不帶手柄 ) Approx.7g(with terminal type and without lever)

### ■訂貨指引 Ordering Instruction

參見第14頁/ Refer to Page 14

## ◆外形尺寸和操作特性 Dimensions and Operating Characteristics

(单位/Unit:mm)

### ◆G5W11-E□□-W□



型号 Part No.	OF Max.		RF Min.		PT Max.	OT Min.	MD Max.	OP (mm)
	(N)	(gf)	(N)	(gf)	(mm)	(mm)	(mm)	
G5W11-EZ015-W□	0.30	30	0.05	5	1.6	0.8	0.4	14.7±0.5
G5W11-EZ025-W□	0.40	40	0.10	10	1.6	0.8	0.4	14.7±0.5
G5W11-EZ050-W□	0.64	65	0.15	15	1.6	0.8	0.4	14.7±0.5
G5W11-EZ100-W□	1.08	110	0.35	35	1.6	0.8	0.4	14.7±0.5
G5W11-EZ200-W□	2.06	210	0.60	60	1.6	0.8	0.4	14.7±0.5

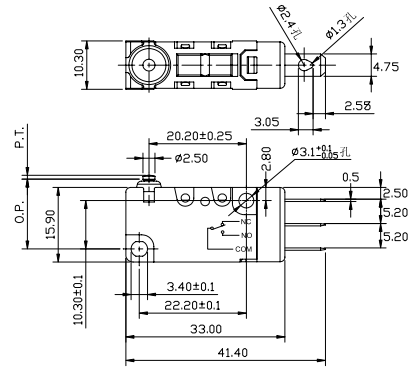

### ◆G5W11-W□□-W□



型号 Part No.	OF Max.		RF Min.		PT Max.	OT Min.	MD Max.	OP (mm)
	(N)	(gf)	(N)	(gf)	(mm)	(mm)	(mm)	
G5W11-WZ015-W□	0.30	30	0.05	5	1.6	0.8	0.4	14.7±0.5
G5W11-WZ025-W□	0.40	40	0.10	10	1.6	0.8	0.4	14.7±0.5
G5W11-WZ050-W□	0.64	65	0.15	15	1.6	0.8	0.4	14.7±0.5
G5W11-WZ100-W□	1.08	110	0.35	35	1.6	0.8	0.4	14.7±0.5
G5W11-WZ200-W□	2.06	210	0.60	60	1.6	0.8	0.4	14.7±0.5

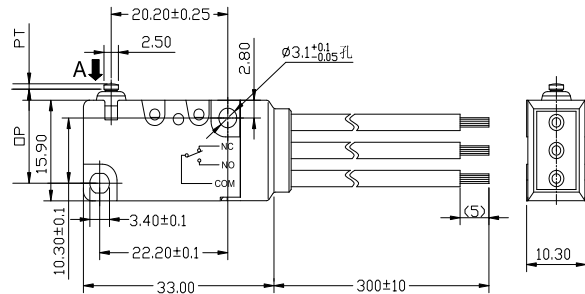

### ◆G5W11-W□□A01-W□

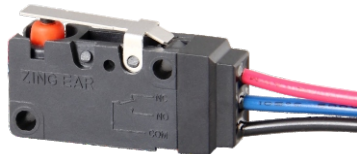

型号 Part No.	OF Max.		RF Min.		PT Max.	OT Min.	MD Max.	OP (mm)
	(N)	(gf)	(N)	(gf)	(mm)	(mm)	(mm)	
G5W11-WZ015A01-W□	0.30	30	0.05	5	1.6	0.8	0.4	15.3±0.5
G5W11-WZ025A01-W□	0.40	40	0.10	10	1.6	0.8	0.4	15.3±0.5
G5W11-WZ050A01-W□	0.64	65	0.15	15	1.6	0.8	0.4	15.3±0.5
G5W11-WZ100A01-W□	1.08	110	0.35	35	1.6	0.8	0.4	15.3±0.5
G5W11-WZ200A01-W□	2.06	210	0.59	60	1.6	0.8	0.4	15.3±0.5

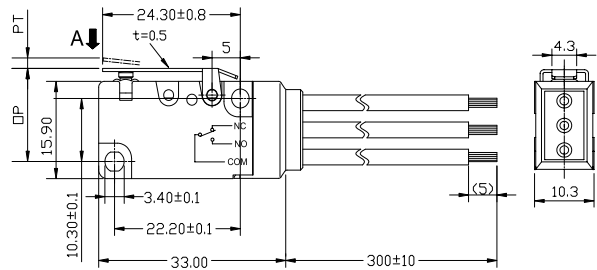

### ◆G5W11-W□□A02-W□

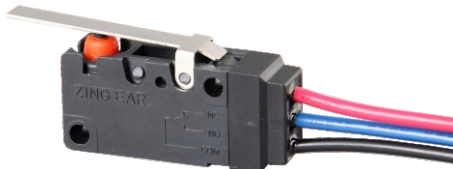

型号 Part No.	OF Max.		RF Min.		PT Max.	OT Min.	MD Max.	OP (mm)
	(N)	(gf)	(N)	(gf)	(mm)	(mm)	(mm)	
G5W11-WZ015A02-W□	0.20	20	0.05	5	3.2	1.3	1.2	15.3±1.5
G5W11-WZ025A02-W□	0.25	25	0.08	8	3.2	1.3	1.2	15.3±1.5
G5W11-WZ050A02-W□	0.40	40	0.15	15	3.2	1.3	1.2	15.3±1.5
G5W11-WZ100A02-W□	0.64	65	0.25	25	3.2	1.3	1.2	15.3±1.5
G5W11-WZ200A02-W□	1.27	130	0.35	35	3.2	1.3	1.2	15.3±1.5

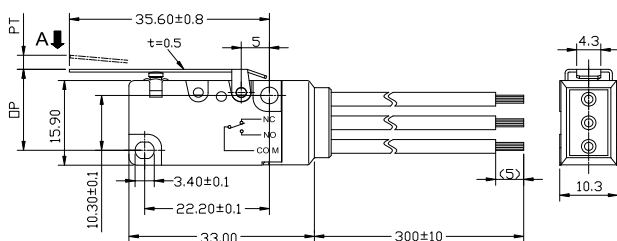

### ◆G5W11-W□□A03-W□



型号 Part No.	OF Max.		RF Min.		PT Max. (mm)	OT Min. (mm)	MD Max. (mm)	OP (mm)
	(N)	(gf)	(N)	(gf)				
G5W11-WZ015A03-W□	0.10	10	0.03	3	6.4	2.6	2.4	15.3±3
G5W11-WZ025A03-W□	0.15	15	0.05	5	6.4	2.6	2.4	15.3±3
G5W11-WZ050A03-W□	0.20	20	0.08	8	6.4	2.6	2.4	15.3±3
G5W11-WZ100A03-W□	0.35	35	0.10	10	6.4	2.6	2.4	15.3±3
G5W11-WZ200A03-W□	0.64	65	0.15	15	6.4	2.6	2.4	15.3±3

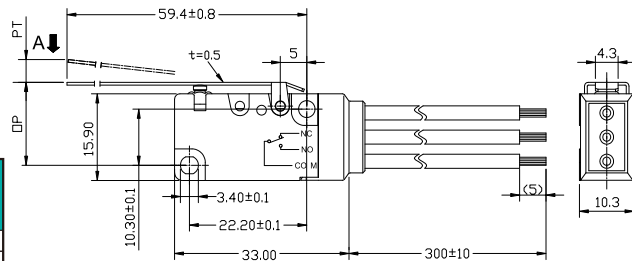

### ◆G5W11-W□□A04-W□



型号 Part No.	OF Max.		RF Min.		PT Max. (mm)	OT Min. (mm)	MD Max. (mm)	OP (mm)
	(N)	(gf)	(N)	(gf)				
G5W11-WZ015A04-W□	0.20	20	0.05	5	3.2	1.3	1.2	18.5±1.5
G5W11-WZ025A04-W□	0.25	25	0.08	8	3.2	1.3	1.2	18.5±1.5
G5W11-WZ050A04-W□	0.40	40	0.15	15	3.2	1.3	1.2	18.5±1.5
G5W11-WZ100A04-W□	0.64	65	0.25	25	3.2	1.3	1.2	18.5±1.5
G5W11-WZ200A04-W□	1.27	130	0.35	35	3.2	1.3	1.2	18.5±1.5

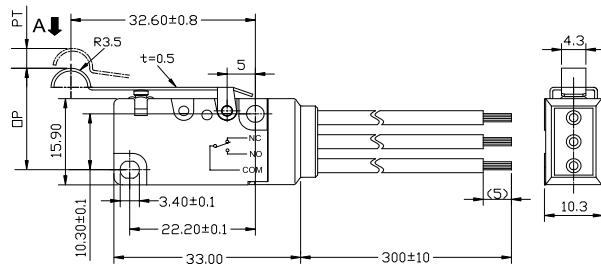

### ◆G5W11-W□□A05-W□

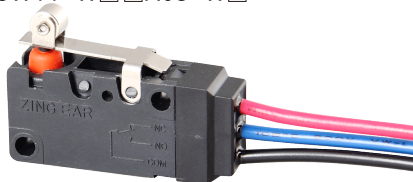

型号 Part No.	OF Max.		RF Min.		PT Max. (mm)	OT Min. (mm)	MD Max. (mm)	OP (mm)
	(N)	(gf)	(N)	(gf)				
G5W11-WZ015A05-W□	0.30	30	0.05	5	1.6	0.8	0.4	20.6±0.8
G5W11-WZ025A05-W□	0.40	40	0.10	10	1.6	0.8	0.4	20.6±0.8
G5W11-WZ050A05-W□	0.64	65	0.15	15	1.6	0.8	0.4	20.6±0.8
G5W11-WZ100A05-W□	1.18	120	0.35	35	1.6	0.8	0.4	20.6±0.8
G5W11-WZ200A05-W□	2.35	240	0.59	60	1.6	0.8	0.4	20.6±0.8

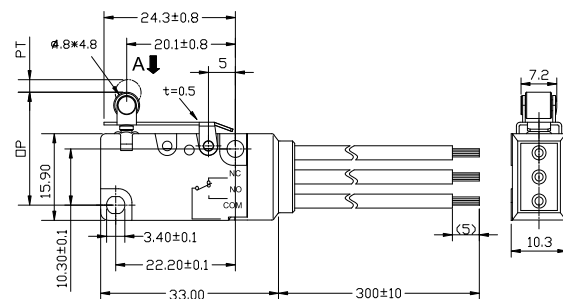

### ◆G5W11-W□□A06-W□



型号 Part No.	OF Max.		RF Min.		PT Max. (mm)	OT Min. (mm)	MD Max. (mm)	OP (mm)
	(N)	(gf)	(N)	(gf)				
G5W11-WZ015A06-W□	0.20	20	0.05	5	3.2	1.3	1.2	20.6±1.6
G5W11-WZ025A06-W□	0.25	25	0.08	8	3.2	1.3	1.2	20.6±1.6
G5W11-WZ050A06-W□	0.40	40	0.15	15	3.2	1.3	1.2	20.6±1.6
G5W11-WZ100A06-W□	0.64	65	0.25	25	3.2	1.3	1.2	20.6±1.6
G5W11-WZ200A06-W□	1.27	130	0.35	35	3.2	1.3	1.2	20.6±1.6

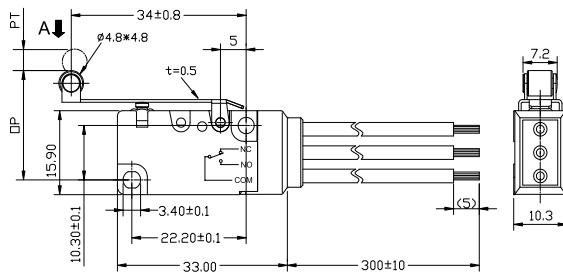

# G5系列 / Series-G5D 門開關 / Door Switch

■ 訂貨指引 Ordering Instruction 參見第14頁/ Refer to Page 14

## ◆ G5D外形尺寸和操作特性/

### Dimensions and Operating Characteristics for G5D series

(單位/Unit:mm)

#### ◆ G5D□□-□□1800F05-U



操作参数/Parameters			
OF Max. (N)	FP Max. (gf)	TTP Min. (mm)	OP Min. (mm)
17.60	1800	9.5	5.16

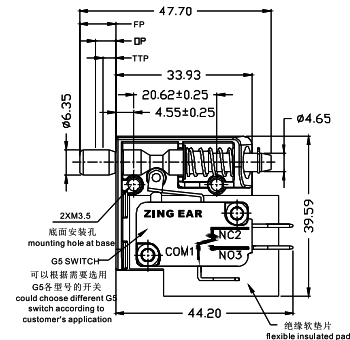
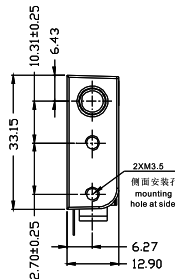

#### ◆ G5D□□-□□1800J05-U

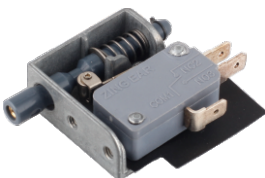

操作参数/Parameters			
OF Max. (N)	FP Max. (gf)	TTP Min. (mm)	OP Min. (mm)
17.60	1800	9.5	5.16

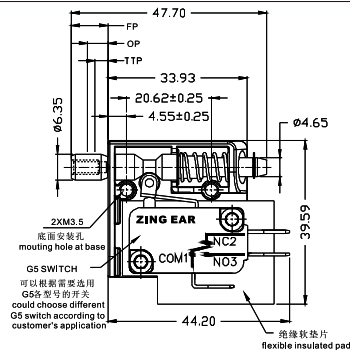
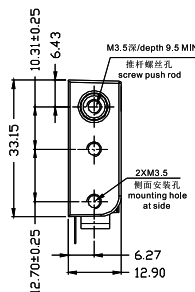

#### ◆ G5D□□-□□1800F05-V



操作参数/Parameters			
OF Max. (N)	FP Max. (gf)	TTP Min. (mm)	OP Min. (mm)
17.60	1800	9.5	5.16

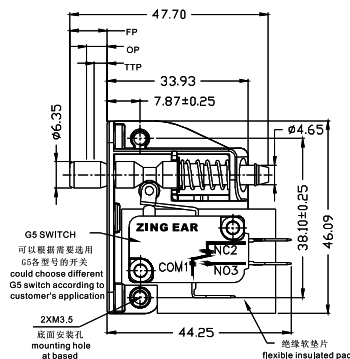
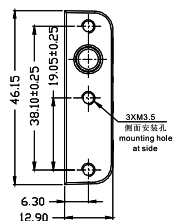

#### ◆ G5D□□-□□1800J05-V



操作参数/Parameters			
OF Max. (N)	FP Max. (gf)	TTP Min. (mm)	OP Min. (mm)
17.60	1800	9.5	5.16

